

AM-CL2845MAN SERIES

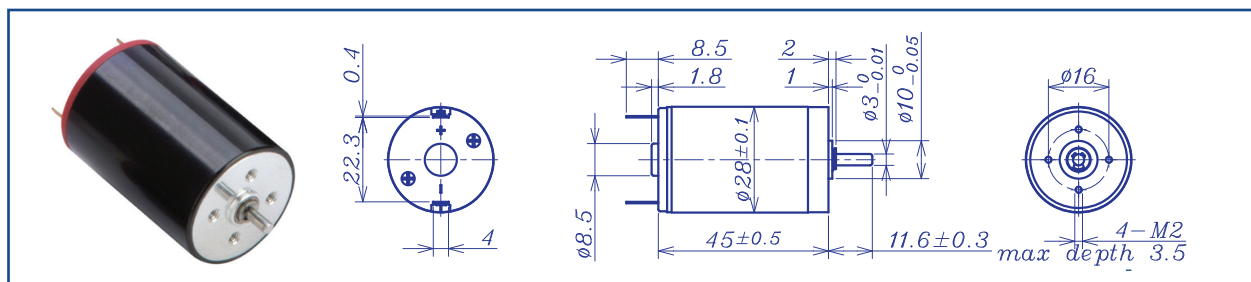

Precious metal brush Ball bearings

Motor Model		0606	0604	1206	1204	2406	2404	4806	4805	
Nominal voltage	V	6	6	12	12	24	24	48	48	
No load speed	±12% rpm	6150	4450	6240	4350	5960	4536	6520	4900	
No load current	Max 150% mA	91	59	53	35	25	12	14	9	
Recommend limit for continuous operating	Max cont. torque	mN.m	8.0	11.4	16.4	21.6	22.8	24.6	29.1	29.9
	Rated speed	rpm	5911	4151	5837	3794	5396	3944	5834	4097
	Rated current	mA	950	950	950	860	620	500	430	330
	Rated power	W	4.9	5.0	10.0	8.6	12.9	10.2	17.8	12.8
Starting current	mA	22222	13333	13953	6486	6316	3750	3967	1967	
Stall torque	mN.m	205.3	170.2	254.3	169.0	240.9	188.3	276.9	182.3	
Maximum power output	W	33.1	19.8	41.5	19.3	37.6	22.4	47.3	23.4	
Maximum efficiency	%	88	87	88	86	88	89	88	87	
Terminal resistance	±12% Ω	0.27	0.45	0.86	1.85	3.80	6.4	12.1	24.4	
Inductance	(1KHZ) mH	0.02	0.05	0.11	0.21	0.47	0.77	1.47	3.00	
Mechanical time constant	ms	6.3	6.0	5.2	5.3	5.1	5.0	4.8	5.3	
Moment of inertia	gcm ²	20.1	21.8	20.4	19.8	19.5	19.8	19.5	19.0	
Torque constant	mN.m/A	9.3	12.8	18.3	26.2	38.3	50.4	70.1	93.1	
Speed constant	rpm/V	1029	745	522	364	249	190	136	103	
Speed/torque gradient	rpm/mN.m	30.0	26.2	24.5	25.7	24.7	24.1	23.5	26.9	
Weight	g	140	140	136	136	136	136	136	136	

ADDITIONAL INFORMATION

Motor thermal resistance:	15.6 K/W	Motor thermal time constant:	1086 S
Axial (dynamic):	7.3 N	Radial (5mm from mounting face):	28.0 N
Press-fit force (static):	60(120)N	Max allowable screw depth into flange:	3.5 mm
Maximum radial play (5mm from mounting face):	≤0.02 mm	Axial play:	Preset
Maximum winding temperature:	85°C	Ambient temperature range:	-30 to °C65
Standard rear shaft diameter:	1.5 mm	Standard rear shaft length "L":	0/3.7 mm

Total Length (Gearbox and Motor): $L_T=L_1+L_2+L_3$

L1:28GP	L1:32GP	L2:CL28	L3: EN16S
25.9	27.4	45.0	10.7
33.1	35.9		
40.3	44.4		

AM-CL2845MAN Combination Scheme

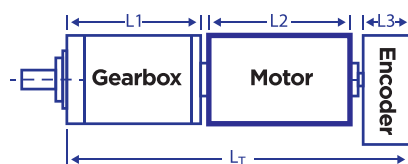

Recommended Gearbox:
Planetary Gearbox:
AM-28GP
AM-32GP

Recommended Encoder:
Encoder S: AM-EN1611S***
2~3 Channels

For more combination specs, visit Assun Motor website.

Remarks: Client can choose gearbox and encoder to match with this motor. Some combinations are listed here for reference.

Motor data tested at 25°C. Motor operation exceeding continuous limits will reduce life or result in damage.
At elevated ambient temperatures, load current must be reduced.

Download datasheet: <https://assunmotor.com/documents-download>

Visit Our Website and Online Shop at <https://assunmotor.com> Contact: info@assunmotor.com