

AM-CL4071GAE SERIES (125 °C)

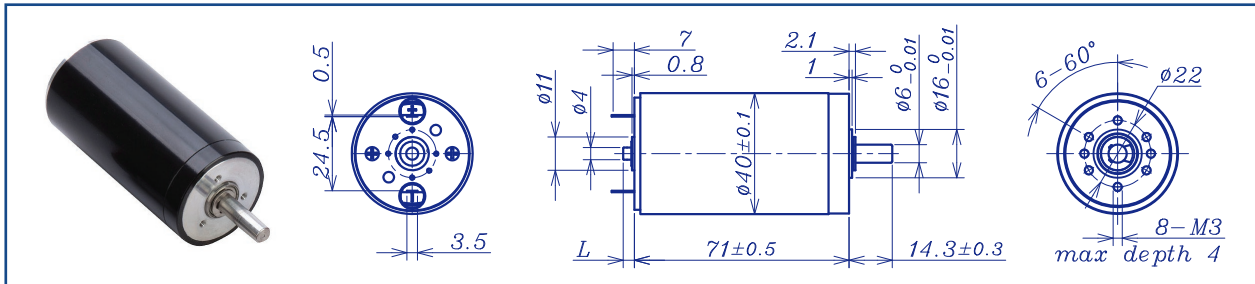

		Graphite brush			Ball Bearings				
Motor Model		1207	2408	4809	4806	4805	4804	4803	4802
Nominal voltage		V	12	24	48	48	48	48	48
No load speed ±12%		rpm	6800	8450	8900	6300	6100	4000	2050
No load current Max 150%		mA	275	170	70	65	56	36	22
Recommend limit for continuous operation	Max cont. torque	mN.m	96.1	144.3	150.6	169.5	153.2	155.6	186.0
	Rated Speed	rpm	6312	7905	8235	5747	5475	3361	2142
	Rated Current	mA	6000	5500	3000	2400	2100	1400	1000
	Rated Power	W	63.5	119.4	130.4	102.0	87.8	54.8	35.6
Starting current		mA	80000	82759	41206	26667	20000	8571	4174
Stall torque		mN.m	1339	2235	2106	1931	1494	974	675
Maximum power output		W	238.4	494.5	490.6	318.4	238.7	102.0	49.5
Maximum Efficiency		%	89	91	92	90	90	87	85
Terminal resistance ±12%		Ω	0.15	0.29	1.17	1.8	2.4	5.6	11.5
Inductance (1KH ₂)		mH		0.08	0.34		0.76		
Mechanical time constant		ms	6.6	4.9	5.3	4.1	5.1	5.3	5.2
Moment of inertia		gcm ²	123.5	122.6	120.8	120.8	120.2	122.2	120.5
Torque constant		mN.m/A	16.8	27.1	51.4	72.6	74.9	114.1	162.7
Speed constant		rpm/V	569	353	186	132	127	84	59
Speed/torque gradient		rpm/mN.m	5.1	3.8	4.2	3.3	4.1	4.1	3.2
Weight		g	495	496	498	495	496	497	495

ADDITIONAL INFORMATION

Motor thermal resistance:	K/W	Motor thermal time constant:	S
Axial (dynamic):	5.5 N	Radial (5mm from mounting face):	29.0 N
Press-fit force (static):	100(1000) N	Max allowable screw depth into flange:	5.0 mm
Maximum radial play (5mm from mounting face):	≤0.02 mm	Axial play:	Preset
Maximum winding temperature:	125°C	Ambient temperature range:	-30 to 65°C
Standard rear shaft diameter:	4 mm	Standard rear shaft length "L":	3.7/5.5 mm

Total Length (Gearbox and Motor) _{T=L1+L2+L3}				
L1:40GP	L1:45GP	L2: CL40	L3:EN22S	L3:EN24T
46.8	60.1	71	10.7	12.0
58.3	72.1			
69.8				

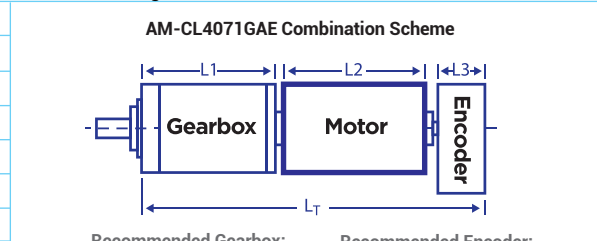

Remarks: Client can choose gearbox and encoder to match with this motor. Some combinations are listed here for reference.

Recommended Gearbox:
Planetary Gearbox:
AM-40GP
AM-45GP

Recommended Encoder:
Encoder S: AM-EN221S***
2~3 Channels
Encoder T: AM-EN241T***
2~3 Channels

For more combination specs, visit Assun Motor website.

Motor data tested at 25°C. Motor operation exceeding continuous limits will reduce life or result in damage. At elevated ambient temperatures, load current must be reduced.

Download datasheet: <https://assunmotor.com/documents-download>

Visit Our Website and Online Shop at <https://assunmotor.com> Contact: info@assunmotor.com