

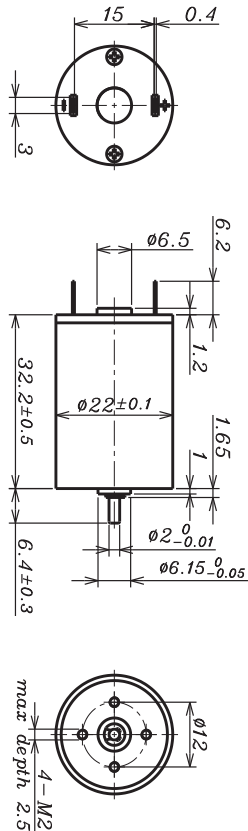

DC Coreless Motor AM-CL2232MA/B Series

ASSUN MOTOR

2015 edition. Specifications are subject to change without notice.



		PRECIOUS METAL BRUSH				BALL BEARING			
MOTOR MODEL		0308	0305	0607	0605	1207	1205	2407	2406
NOMINAL VOLTAGE	V	3	3	6	6	12	12	24	24
NO LOAD SPEED ±12%	rpm	7600	4500	6998	5006	6548	4986	7048	6167
NO LOAD CURRENT Max 150%	mA	55	30	27	14	10.2	7	6.5	8.5
	mN.m	3.2	5.2	5.9	7.2	6.8	7.8	6.9	7.1
Recommend Limit for Continuous Operating	rpm	6998	3745	6083	3843	5448	3769	5901	504.1
	mA	900	850	750	650	400	350	220	200
	W	2.3	2.0	3.8	2.9	3.9	3.1	4.3	3.7
STARTING CURRENT	mA	10714	4918	5556	2752	2330	1412	1319	1057
STALL TORQUE	mN.m	40	31	45	31	40	32	42	39
MAXIMUM POWER OUTPUT	W	8.0	3.6	8.3	4.1	6.9	4.2	7.8	6.2
MAXIMUM EFFICIENCY	%	86	85	87	86	87	86	86	83
TERMINAL RESISTANCE PHASE TO PHASE ±12%	Ω	0.28	0.61	1.08	2.18	5.15	8.50	18.2	22.7
INDUCTANCE (1kHz)	mH	0.36	0.09	0.23	0.44	0.7	3.01	4.01	5.01
MECHANICAL TIME CONSTANT	ms	11.4	9.2	9.8	9.9	9.8	9.5	9.6	9.3
MOMENT OF INERTIA	gcm²	5.75	6.02	6.02	5.88	5.75	5.82	5.55	5.55
TORQUE CONSTANT	mN.m/A	3.8	6.3	8.1	11.4	17.4	22.9	32.4	36.9
SPEED CONSTANT	rpm/V	2546	1509	1172	839	548	41.8	32.4	259
SPEED/TORQUE GRADIENT	rpm/mN.m	190.1	145.5	155.4	160.5	162.0	155.2	166.0	159.5
WEIGHT	g	56.4	56.9	56.9	56.7	56.5	56.6	56.3	56.3

ADDITIONAL INFORMATION			
MAXIMUM ROLLING BEARING LOADS			
AXIAL (DYNAMIX)	5.9 N	RADIAL (5MM FROM HEAD FACE)	8.0 N
PRESS-FIT FORCE	16(90) N	L: MAX ALLOWABLE SCREW DEPTH INTO FLANGE	2.5 mm
MAXIMUM RADIAL PLAY	≤0.02mm	AXIAL PLAY:	PRESET
MAXIMUM WINDING TEMPERATURE	85 °C	AMBIENT TEMPERATURE RANGE:	-30 to 65 °C

AM-CL2232MA/B COMBINATION SCHEME

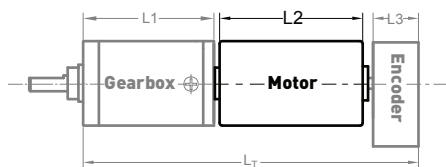

Recommend Gearbox:
Planetary Gearbox:
AM-22P

Recommend Encoder:
Encoder S: AM-EN22-S***
2~3 Channels

TOTAL LENGTH (GEARBOX AND MOTOR): $L_T = L_1 + L_2 + L_3$		
L1:22P	L2: CL22	L3:EN22-S
22.4	32.0	10.7
27.5		
32.5		
37.5		
42.6		

For more gearbox specs, see Assun Motor website.

REMARKS

Clients can choose gearbox and encoder to match with this motor. Some combinations are listed here for reference.

Motor Data Tested at 25°. Motor Operation exceeds continuous limits of operating range will compromise the life of the device.

ASSUN MOTOR

www.assunmotor.com | info@assunmotor.com